

DATA SHEET: TEMBREAK 2 S1250-SE MCCB

MCCB Electrical Characteristics to IEC 60947-2, EN 60947-2, JIS C 8201-2-1 ANN. 1, AS/NZS 3947-2, NEMA AB-1

Frame reference	Quantity	Unit	Condition	TB2 1250
Max In (A) of Frame				1250
Model				S1250
Number of Poles				3, 4
Type				SE
Nominal current ratings				
	I_n	(A)	50°C	1250
Electrical characteristics				
Rated operational voltage	U_e	(V)	AC 50/60 Hz DC	690 -
Rated insulation voltage	U_i	(V)		800
Rated impulse withstand voltage	U_{imp}	(kV)		8
Ultimate breaking capacity (IEC, JIS, AS/NZS)	I_{cu}	(kA)	690V AC	20 ^①
			525V AC	30
			440V AC	45
			400/415V AC	50
			220/240V AC	85
			250V DC	-
Service breaking capacity (IEC, JIS, AS/NZS)	I_{cs}	(kA)	690V AC	15 ^①
			525V AC	23
			440V AC	34
			400/415V AC	38
			220/240V AC	65
			250V DC	-
Rated breaking capacity (NEMA)		(kA)	480V AC 240V AC	30 85
Rated short-time withstand current	I_{cw}	(kA)	0.3 Seconds	15
Protection				
Adjustable thermal, adjustable magnetic				■
Fixed thermal, fixed magnetic				■
Microprocessor				●
Utilisation category				B
Installation				
Front connection (FC)				-
Extension bar (FB)				■
Cable clamp (FW)				-
Rear connection (RC)				●
Plug-in (PM)				●
DIN rail mounting (DA)				-
Dimensions	height	(mm)		370
	width	(mm)	3 pole 4 pole	210 280
	depth	(mm)		120
	weight	(kg)	3 pole 4 pole	19.8 25.0
Operation				
Direct Opening Action				■
Toggle operation				■
Door mounted (HS) / Breaker mounted handle (HB)				●
Motor operation (MC)				●
Endurance	Electrical		690V AC	4,000
	Mechanical	cycles cycles		5,000

① MCCB cannot be used in IT systems at this voltage

DATA SHEET: TEMBREAK 2 S1250-SE MCCB

Outline Dimensions S1250-SE

ASL: Arrangement Standard Line $\overline{\text{HL}}$: Handle Frame Centre Line

Front connected

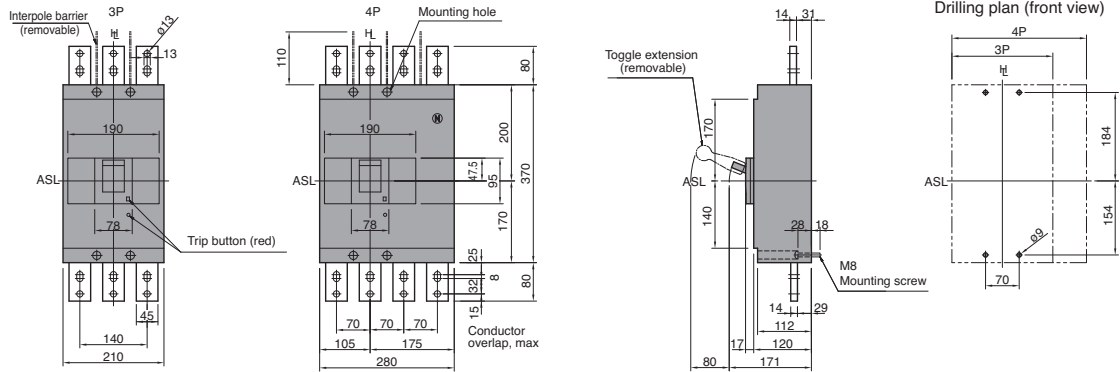

Rear connected

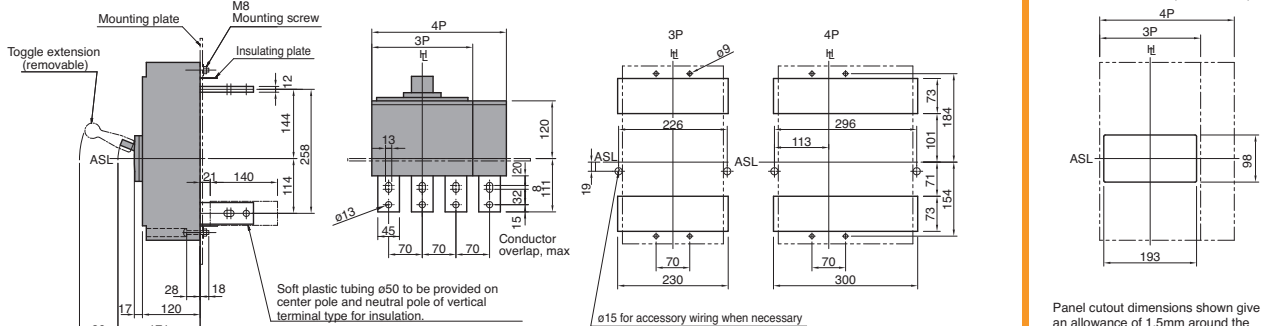

Note: Studs are factory installed in horizontal direction both on the line and load sides.

Front connected with Motor Operator

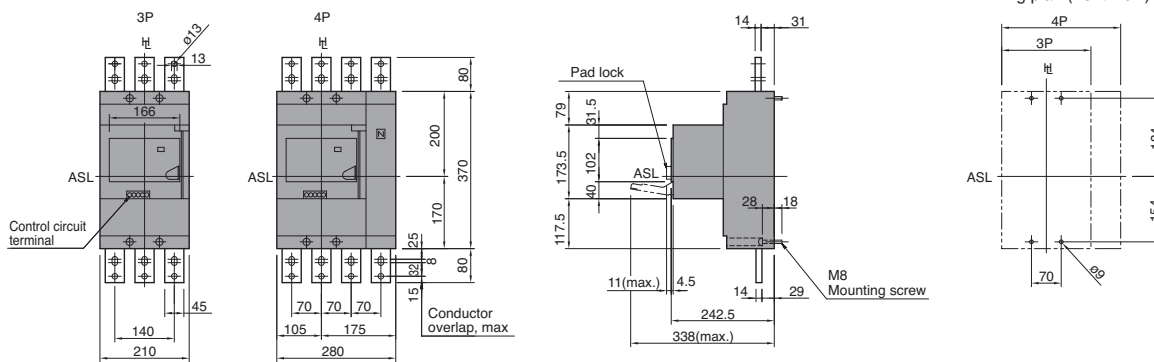

Rear connected with Motor Operator

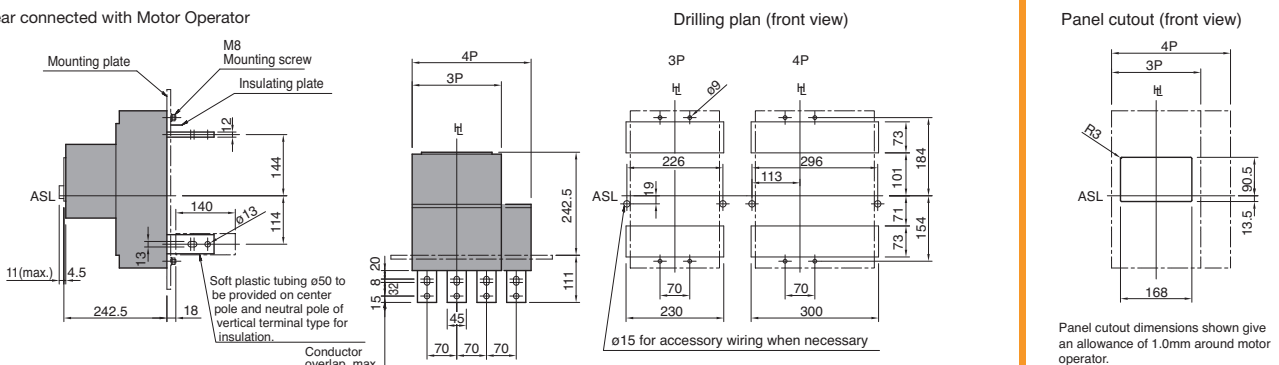

Note: Studs are factory installed in horizontal direction both on the line and load sides.

DATA SHEET: TEMBREAK 2 S1250-SE MCCB

Outline Dimensions S1250-SE Plug in Version

ASL: Arrangement Standard Line H₁: Handle Frame Centre Line

Plug-in

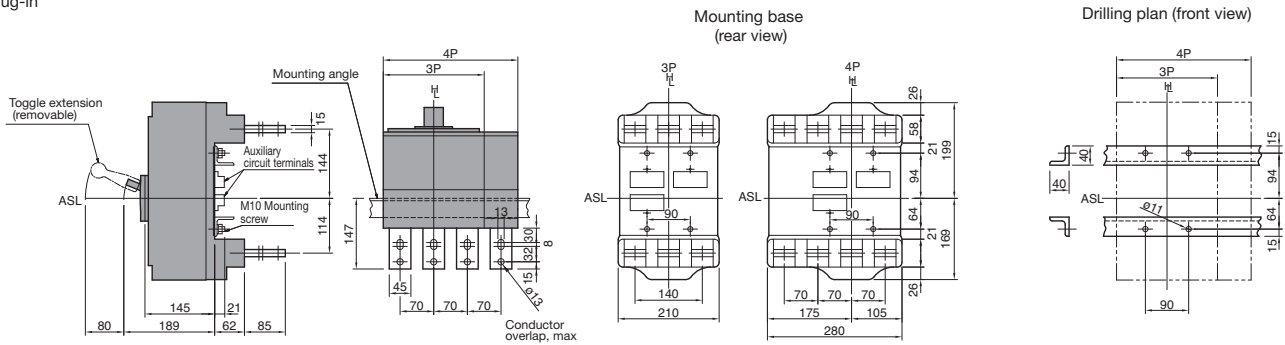

Plug-in with Motor Operator

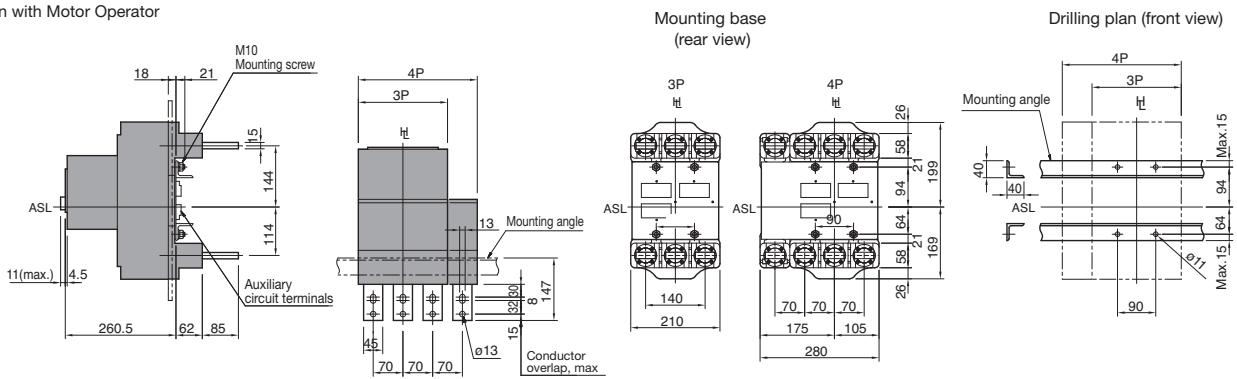

Panel cutout (front view)

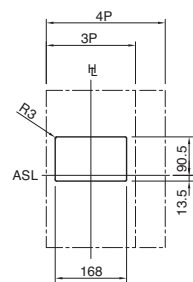

Panel cutout dimensions shown give an allowance of 1.0mm around motor operator.

DATA SHEET: TEMBREAK 2 S1250-SE MCCB

Time/Current Characteristic Curves

S1250-SE

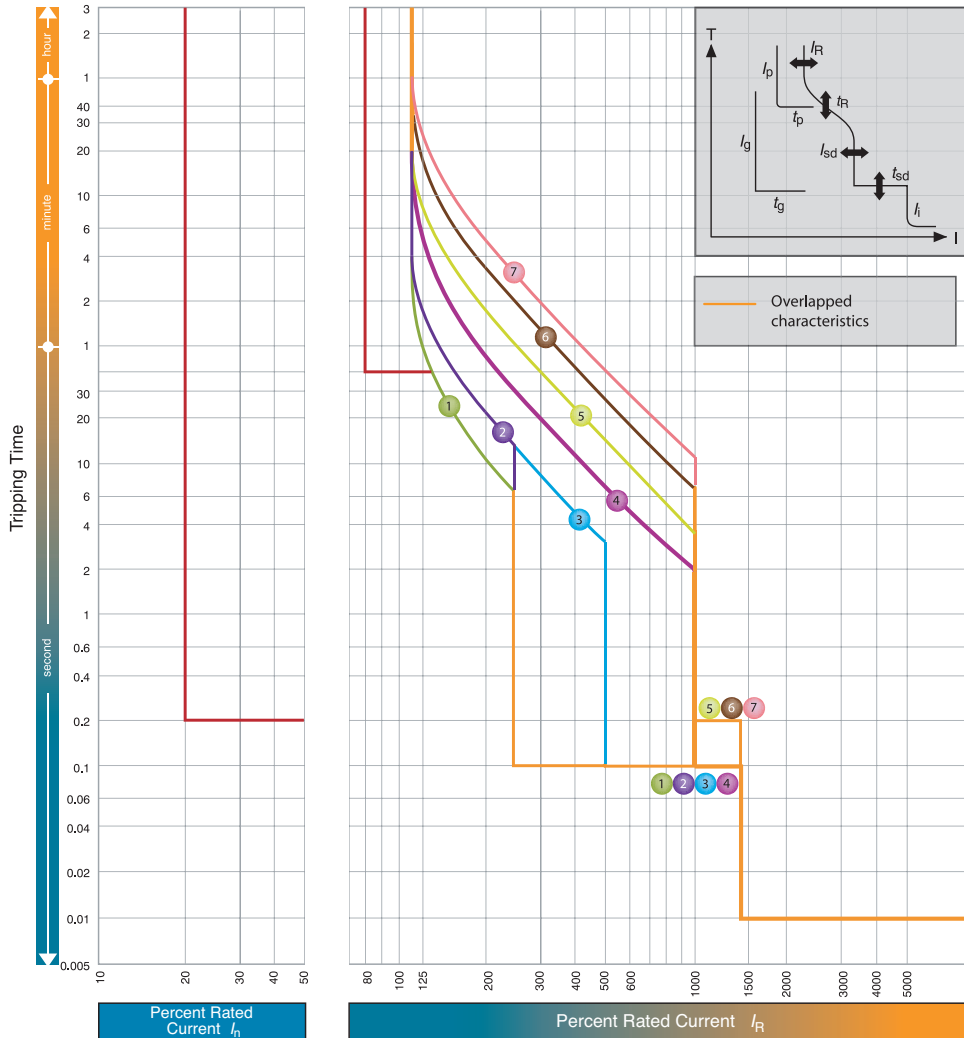

$I_n = 1250A$

		I_R (A)									
		LTD Pick-up current	I_R	x/I_n	0.4	0.5	0.63	0.8	0.9	0.95	1.0
Standard	LT	t_R	(s)		11	21	21	5	10	19	29
	ST	I_{sd}	x/I_R		2.5			5			
		t_{sd}	(s)		0.1			10			
	INST	I_i	x/I_n		14(Max: $12 \times I_n$) Note (1)						
Option	PTA	I_p	x/I_R		0.8						
		t_p	(s)		40						
	GF Note(3)	I_g	x/I_n		0.2						
		t_g	(s)		0.2						
	NP	I_N	x/I_R		1.0/0.5 Note(2)						
	t_N	(s)		$t_N = t_R$							

Note

(1) I_i max. = $12 \times I_n$. (2) $1.0 \times I_R$ or $0.5 \times I_R$ can be selected. Characteristic of neutral protection (t_N vs. I_N) is identical to characteristic of phase protection (t_R vs. I_R). (3) When you specify GF on MCCBs with 3 poles the terminal block is automatically fitted to connect with the external neutral CT for 3 phases 4 wires system.